



RPH-16 & RPH-20 Public Address Horns Assembly Instructions

Contents of hardware package:

2 large hex bolts
2 large split-ring lockwashers
2 large hex nuts

2 large flat washers
2 black rubber flat washers
2 plastic inner mounting bosses

2 plastic outer mounting bosses
3 small hex screws
3 small flat washers

Step one:

Insert one large hex bolt through one inner mounting boss, and position on one of the two yoke mounting holes on the inside of the horn bell. The inner mounting boss has a hex-shaped indentation for the bolt head to rest in. Be sure to place the boss so that the arrow is pointing toward the mouth or large opening of the horn. You may find it helpful to put a piece of tape over the bolt head and boss to hold them in position while repeating the procedure on the other side.

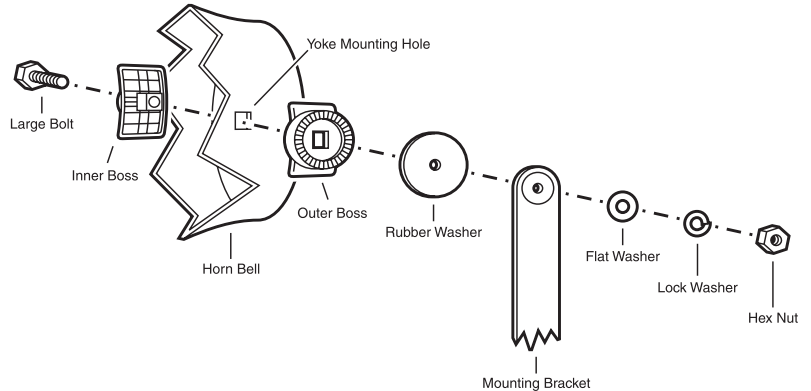

Step two:

With both inner bosses and hex bolts in place, position one outside mounting boss on a protruding hex bolt, again taking care to align the boss with the arrows pointing to the front of the horn. Hold the inner boss and bolt with one hand, and place one rubber washer over the boss.

Step three:

While still holding the hardware from the inside, slip one end of the U-shaped mounting bracket over the bolt, capturing the rubber washer. Place one flat washer, one split ring lockwasher, and one hex nut over the bolt and thread loosely to hold in place.

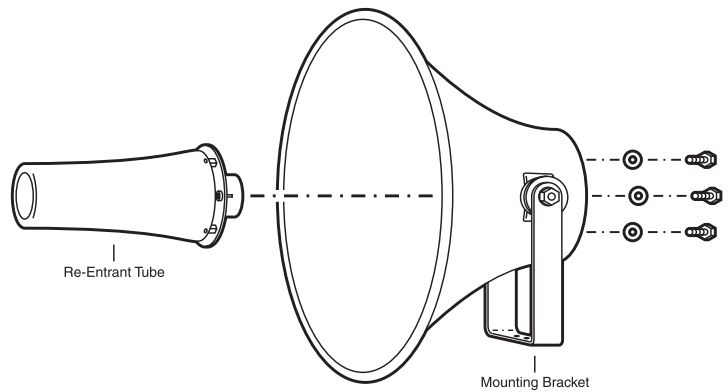

Step four:

Gently spread the mounting bracket to attach to the opposite mounting boss, ensuring that the bolt passes through, and that a second rubber washer is captured between the bracket and the mounting boss. Place a flat washer, a lockwasher, and a hex nut on the bolt and fasten finger-tight.

Step five:

Align the three threaded mounting holes on the re-entrant tube with the holes on the back or small end of the main horn assembly. Start a small bolt and washer into each hole, and then tighten with a wrench.

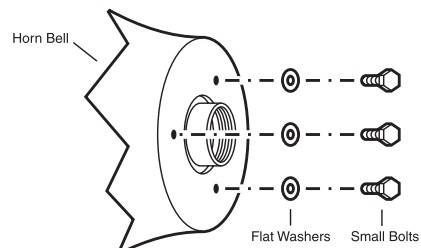

Step six:

Mount the compression driver of your choice. Tighten the two large bolts on the mounting bracket, taking care to not overtighten them.